

PICZO

ANDROID SMART PROJECTOR QUICK START GUIDE



Thank you for purchasing our DLP mini projector. Please read this manual carefully and keep it in a safe place for future reference.

BRIEF INTRODUCTION

1.1 Package Contents



1

1.2 Appearance Design

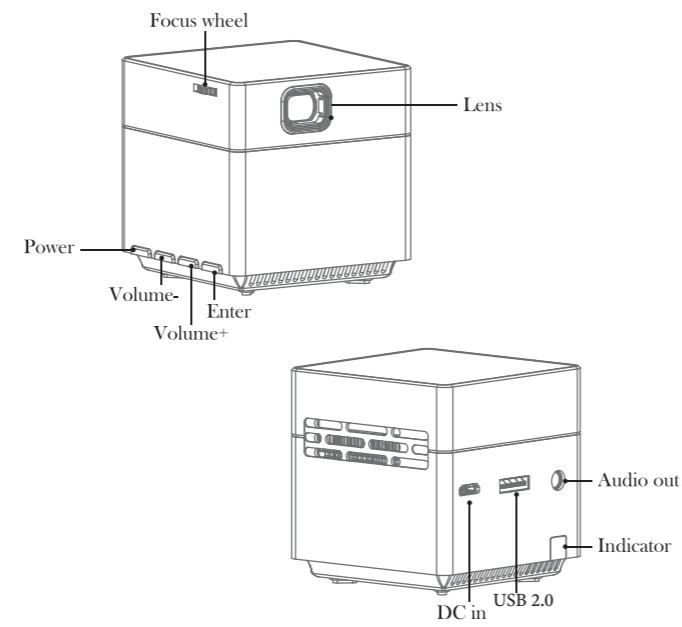

2

OTG function:

You can connect USB mouse and keyboard to the USB host.

You can copy files stored in the internal storage to USB memory and vice versa.

1.3 Remote Control



3

Air Mouse Remote Pairing

1. Enter "Bluetooth Setting" in "Setting"
2. Hold the "OK" and "VOLUME-" key 5 seconds to turn on the Bluetooth function of remote. The red indicator of remote will flash quickly when bluetooth function is opened.
3. Select "Scan For Devices">"Available Devices"> Select "SONG-1" and connect.

Turn On and Turn Off

1. After "SONG-1" connected successfully, click " " in the remote to start Air Mouse function.
2. Click " " in the remote again, the Air Mouse function will be closed, and the Arrow mark will disappear after 15 seconds or press "Back" key in the remote.

BASIC OPERATION OF THE

2.1 Power on / Power off

1. Power on
In battery mode, holding power button 5 seconds (P1).
In charging mode, holding power button 5 seconds (P1), or holding power key of remote 5s seconds (P2).

4

2. Power off
In battery mode, holding power button 5 seconds (P1).
In charging mode, holding power button 5 seconds (P1), or holding power key of remote 5s seconds (P2).

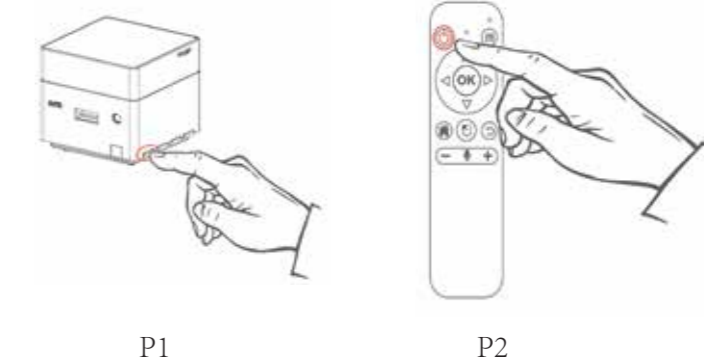

P1

P2

2.2 Adjust focus/brightness

1. Adjust focus
Slide the focus wheel to adjust the screen's definition.
2. Adjust brightness and Projection mode
Enter "Setting" on the home screen, and select "Projector setting" to adjust.

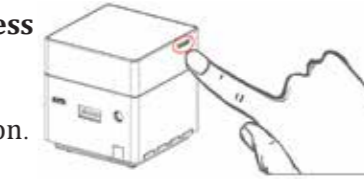

(P3)

5

2.3 Wi-Fi Connecting

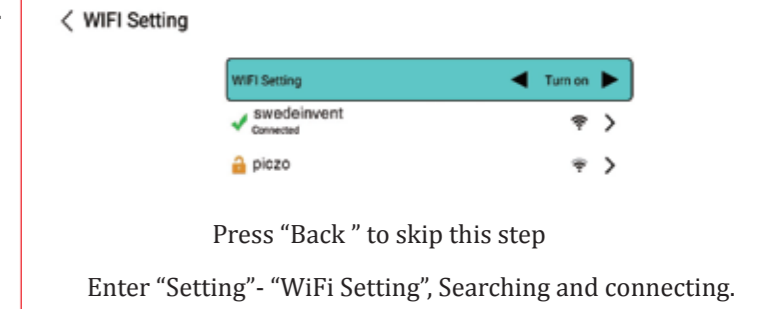

Press "Back" to skip this step

Enter "Setting" - "WiFi Setting", Searching and connecting.

2.4 Interface Display

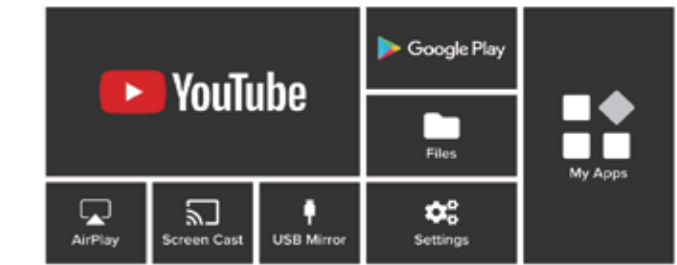

6

2.5 Files USB

This port can be used for Wired Mirror function and U disk playing. Insert the USB drive to playback contents, you can use the keys on the projector or remote controller to select Movie, Picture or Music.

2.6 Google Play User can download apps from Google Play.

2.7 Airplay 1. iPhone

1. In Wi-Fi environment: Go to iPhone's "Setting"----"Wi-Fi", then connect your phone and projector to the same network.

No Wi-Fi environment: Go to iPhone's "Setting"----"Personal Hotspot". Open "Hotspot", then connect projector to it; Or go to the projector's "Setting"----"Network Settings"----"Network Hotspot", open the hotspot and connect iPhone to the hotspot.

2. Back to the phone homepage, slide upward of iOS equipment to display the hidden menu and click "Airplay".

3. Choose ID "PICZO 1.WA", then open "Mirroring" and done.

7



Enter phone settings
Connect same Wifi as projector
Slide upward from the bottom of iOS equipment to display the hidden menu



Choose Airplay
Choose Projector, and switch mirroring to green, mirroring start.

8

2. Mac

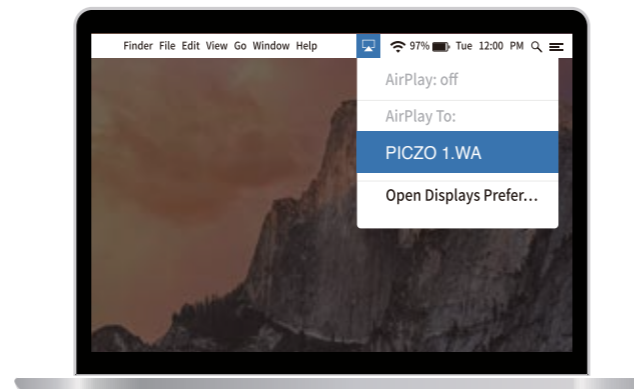

1. Projector Networked: Click " ", connect it to projector through the same network.

2. Click " ", choose ID "PICZO 1.WA" and be done.

- Tips: 1. The performance of mirroring the media would be affected by obstructions or distance between the device and the projector.
2. For better effect of streaming mirroring, please use it in good WiFi environment.

9

2.8 Miracast (Android)

Method 1: Turn on the Android phone. Settings-More Networks-Screen Mirroring-Choose the ID on the list. After successfully connected. The projection image will be mirrored with your phone.

Method 2: Slide downward from the top of Android OS equipment to display the hidden menu-Select "Screen Mirroring"- Choose ID on the list. After successfully connected, the projection image will be the same as the image on your phone.

Note: Different brand may have different wireless connection name and settings. Please refer to the manual of each equipment.

For example, Samsung Note5/6/7 named "SmartView" for wireless mirroring. See the following pictures from left to right.

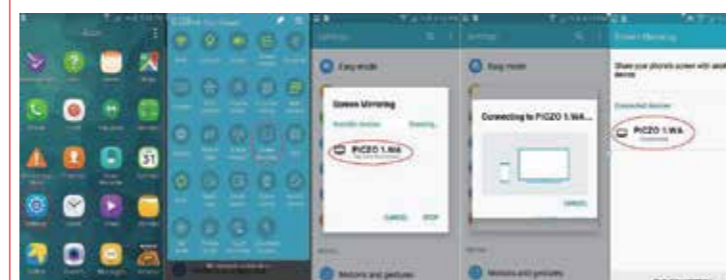

10

4. USB Mirror (iPhone/iPad)

1. Please connect iPhone to the projector as below shown.

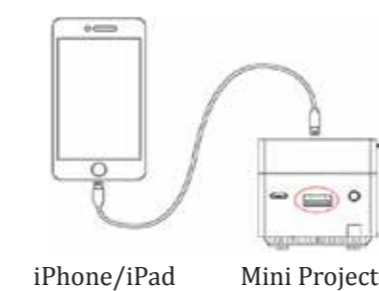

iPhone/iPad Mini Projector

2. Click the "Trust" option, then start mirroring.



Tip: 1. Connection takes about 45 seconds for the first time, please be patient.

2. Recommend the original lighting charging cable. The user must use the cable which supports data transfer.

11

HOW TO UPDATE FIRMWARE

Online update

1. Connect device to the network.
2. Click "Setting" - "General" - "Online Upgrade".
3. Please refer to the hint of update.

Local update

1. Ask the new firmware from local seller.
2. Copy the firmware file "update.zip" to TF card/U disk.
3. Projector will search the firmware automatically.
4. Click update button according to the hint.

CHARGING

The projector can be powered by AC adapter or internal rechargeable battery. To have maximum battery life, it is highly suggested to charge the battery for at least 2 hours the first time.

1. Ensure the projector is turned off and connect it to the power charger.
2. Insert the plug of the power charger into the wall outlet to charge the battery.

Indicator Lights Status

Red Light	Turn off	Turn on
Charging	Charging	Charging
Blue Light	×	Working

12

SPECIFICATIONS

Display Technology	DLP
Brightness(ANSI)	100 Lumens
Native Resolution	FWVGA(854*480)
Compatible Resolution	640*480~1920*1080 (Up to 1080P)
Light source	RGB 3LED OSRAM
LED working life	Above 30000 hrs
Projector Lens	Manual Zoom
Operation System	Android 7.1.2
CPU	RK3128 (Cortex A7 Quad-Core, 1.2GHz)
Memory	RAM:DDR3 1G + ROM Flash memory 16GB(EMMC 5.1)
Wi-Fi	802.11 a/b/g/n/ac (2.4/5.0 GHz dual band)
Wireless mirror	Airplay for iOS devices; Miracast for Android devices; DLNA
Wired Mirror	For iOS devices only (USB port)
Bluetooth	4.0
Keystone Correction	Support ; Vertical ±45 degree; Horizontal ±45 degree
Projection Methods	Front/Rear/Ceiling
Operation Methods	Remote, Mouse, Physical Buttons
Application	Compatible with thousands of Apps.
Interface	USB X1 Multimedia Play & Wired Mirror DC X1 (Micro USB type)
	3.5mm stereo audio output *1
Built-in Speaker	8 ohm 1.5W(X1)
Built-in Battery	Li-Polymer 2850mAh
Working time	2hrs(Approx.)
Projector Size (mm)	55(D) x 55(W) x 55(H)
Net Weight	174g
Power supply	DC 5V/2A

Note : The specifications are subject to change without notice.

13